

NOTES:
 1. DUE TO OUR CONTINUOUS IMPROVEMENT PROGRAM, ALL MODELS AND SPECIFICATIONS ARE SUBJECT TO CHANGE WITHOUT NOTICE.

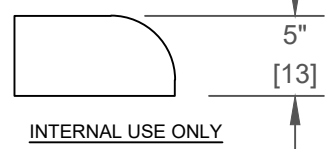
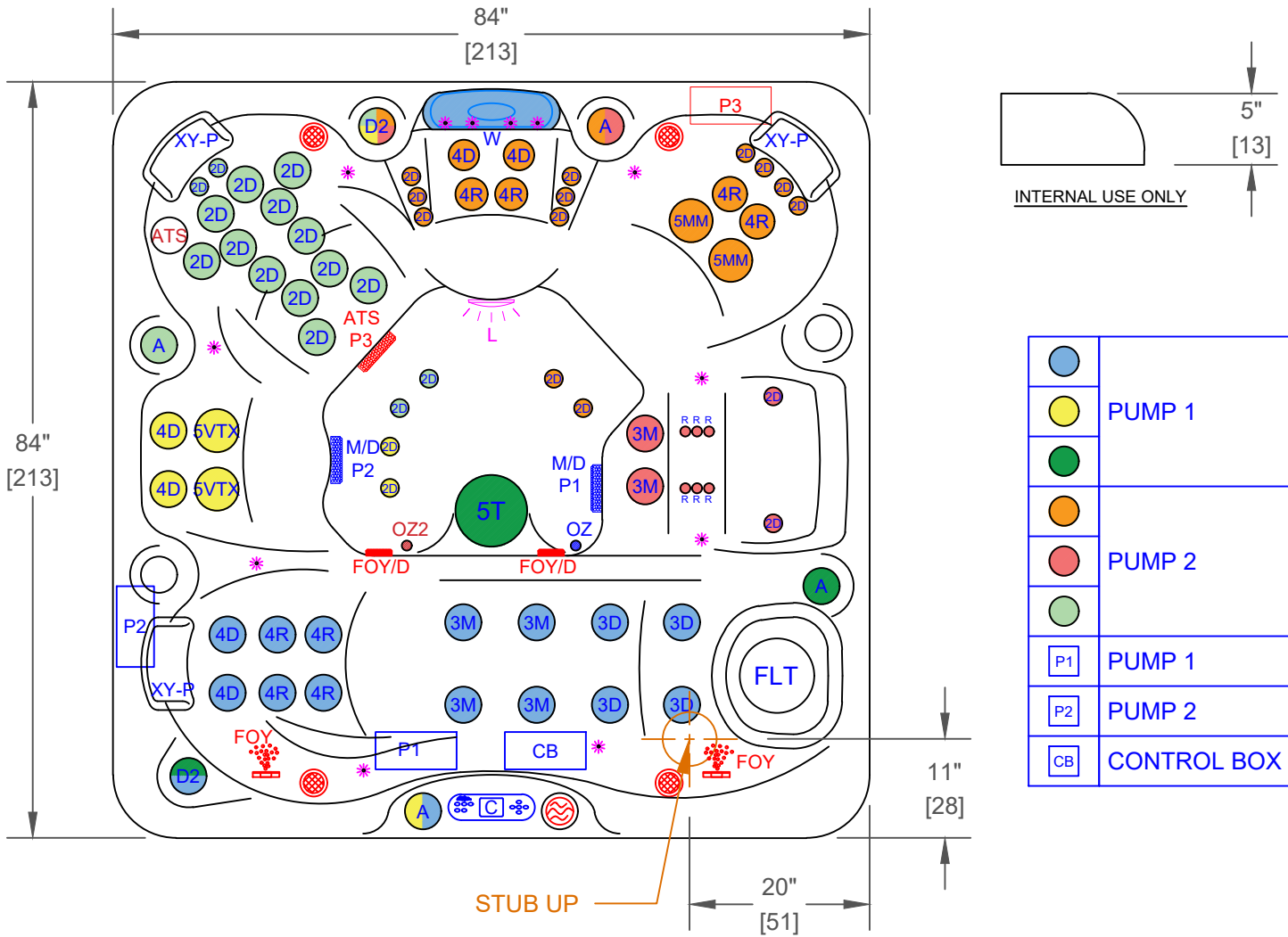

	PUMP 1
	PUMP 2
	PUMP 1
	PUMP 2
	CONTROL BOX

EC-767L - LEGEND			
SYMB.	DESCRIPTION	PART NUMBER	QTY.
R	RAIN JET	PLU23028-392-000	6
2D	2" CLUSTER STORM DIRECTIONAL VELOCITY	PLUCS2441009S-CDCL	32
3D	3" MINI STORM DIRECTIONAL VELOCITY	PLUCS2442009SS-CDCL	4
3M	3" MINI STORM MESSAGE DIRECTIONAL VELOCITY	PLUCS2442059S-CDCL	6
4D	4" POLY STORM DIRECTIONAL VELOCITY	PLUCS2443009SS-CDCL	6
4R	4" POLY STORM ROTO VELOCITY	PLUCS2443029SS-CDCL	8
5VTX	5" POWER STORM TRI DIRECTIONAL VELOCITY	PLUCS2444019S-CDCL	2
5MM	5" POWER STORM MULTI MESSAGE VELOCITY	PLUCS2444059S-CDCL	2
5T	5" ADJUSTABLE WHIRLPOOL VELOCITY WITH VALVE	PLUCS2394009S-CDCL	1
D2	VELOCITY 2" WATER DIVERTER VALVE	PLUCS6053309-CDCL	2
A	VELOCITY AIR CONTROL VALVE	PLUCS6603709-CDCL	4
W	LED WATERFALL		1
FLT	50 SQ. FT. BIO-CLEAN FILTER WITH TELEWEIR	PLU510-9559-CDCL	1
M/D	MAIN DRAIN	PLU644-5219-CDCL V	2
XY-P	TEXTURED Y-PILLOW		3
C	TP700		1
OZ	PURE SILK OZONATOR WITH MAZZIE INJECTOR AND MIXING CHAMBER		1
L	5" MULTI COLORED LED LIGHT		1
*	PERIMETER LED LIGHTING		1

OPTIONS		
SYMB.	DESCRIPTION	OPTION NUMBER
ATS	EXCLUSIVE ADJUSTABLE THERAPY SYSTEM PLUS (ATS PLUS)	OPT23-109
P3	ADDITIONAL 3RD PUMP 1 X 6 BHP (OPTION WILL UPGRADE CONTROL BOX TO BP501X)	OPT23-138B-3P N/A WITH ATS OR 24/7
OZ2	TWIN PURE SILK SYSTEM DIAL OZONATORS WITH MAZZIE INJECTORS AND MIXING CHAMBERS	OPT23-102DX-1
	CAL SPAS SALT SYSTEM	OPT23-113S
-	PURE CURE UV PURIFICATION SYSTEM	OPT23-191B
	24/7 FILTRATION SYSTEM	OPT23-112C
FOY	FOUNTAIN OF YOUTH SYSTEM	OPT23-FOY
-	ABS MOLDED BOTTOM TRAY	OPT23-990-7
-	CAL CONNECT RF MODULE	OPT23-168RF
-	ELITE HORIZONTAL CABINET PANELS AND BLACK BEAM CORNERS (COLORS: GREY, MOCHA, LIME OAK)	OPT23-E981
	FREEDOM SOUND SYSTEM BLUETOOTH, POWERED SUBWOOFER AND 4X SPEAKERS	OPT23-FS43
-	THERMO-GUARD FULL FOAM	OPT23-900

PROPRIETARY AND CONFIDENTIAL THE INFORMATION CONTAINED IN THIS DRAWING IS THE SOLE PROPERTY OF CAL SPAS. ANY REPRODUCTION IN PART OR AS A WHOLE WITHOUT THE WRITTEN PERMISSION OF CAL SPAS IS PROHIBITED.		 CAL SPAS INC. 1462 EAST NINTH STREET, POMONA, CA 91766	
SPECIFICATIONS		TITLE	JET LAYOUT - 113S
DIMENSION (in)	84"x84"x40-1/2"	LINE	ESCAPE
DIMENSION (cm)	213x213x100	MODEL	2024 SPA LINE COSTA
DRY WEIGHT	800 LBS [363 Kg]	NUM	EC-767L
FILLED WEIGHT	4340 LBS [1969 Kg]	DWG NO.	CS003034
		REV	A
WATER CAP.	425 GAL [1609 L]	SCALE	NTS
			SHEET 1 OF 1